

SPM-W34

Image



Key Features

- 1/4" CMOS Sensor
- VGA (640 X 480)
- WDR (Wide Dynamic Range)
- Digital output
- DC 9.5V ~ 16V
- 32mm x 32mm

Ordering Number

- SPM-W34N : NTSC
- SPM-W34P : PAL
- SPM-W34D : Digital output

Dimensions

Unit : mm

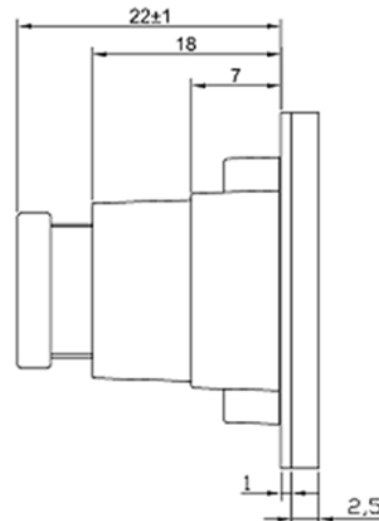
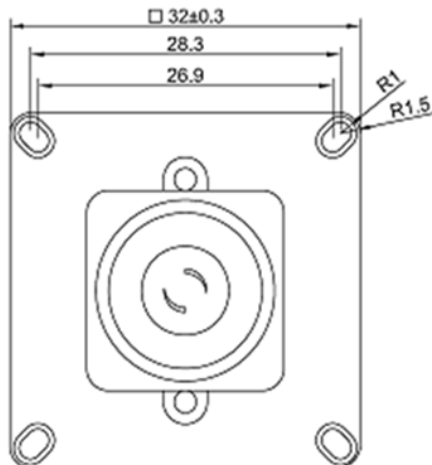

Technical Specifications

	NTSC	PAL
VIDEO		
Imaging Device	1/4 Inch CMOS Sensor	
Signal System	NTSC	PAL
Effective Pixels Number	640(H) x 480(V)	
Scanning System	2:1 Interlace	
Sync System	Internal	
Scanning Frequency	15.734KHz(H)/59.94Hz(V)	15.625KHz(H)/50Hz(V)
Horizontal Resolution	420TV Lines	
Min. Illumination	2.5 V / lux-sec	
S/N Ratio	More than 36dB (AGC OFF)	
Video output	CVBS : 1.0Vp-p / 75Ω Composite	
OPERATIONAL		
Shutter Type	Electronic Rolling Shutter	
Brightness	Auto	
AGC(Auto Gain Control)	Auto	
Backlight Compensation	WDR	
Wide Dynamic Range	120 [dB]	
White Balance	AWC	
D-Effect	Off / Mirror / Rotate / V-Flip (Option)	
ENVIRONMENTAL		
Operating Temperature	-10°C ~ +50°C (+14°F ~ +122°F)	
Operating Humidity	Less than 80% RH	
ELECTRICAL		
Input Voltage	DC12V ±10%	
Power Consumption	Max. 0.5W	
MECHANICAL		
Dimensions	32 x 32 x t 1.0mm	
Weight	T.B.D	